

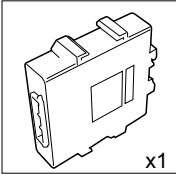

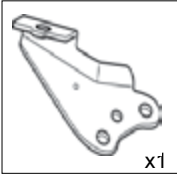

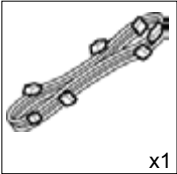

Part #: PT398-48112

Conflicts:

Will not Program with Techstream Lite.

Kit Contents

<p>RES ECU</p>  <p>x1</p> <p>PT398-0T097</p>	<p>RES ECU Bracket</p>  <p>x1</p>	<p>RES Harness</p>  <p>x1</p>	<p>Key Tag</p>  <p>English x2 Spanish x2</p> <p>(E) PT398-60086 (S) PT398-60087</p>	<p>Engine Room Label</p>  <p>English x1 Spanish x1</p> <p>(E) PT398-00070-EL (S) PT398-00070-SL</p>	<p>Remote Label</p>  <p>English x2 Spanish x2</p> <p>(E) 08192-07820 (S) PT398-00070-CL</p>	<p>Window Label</p>  <p>English x2 Spanish x2</p> <p>(E) PT398-60088 (S) PT398-60089</p>
<p>Owner's Guide</p>  <p>x1</p>	<p>M5 Screw</p>  <p>x2</p>					

Service Part #s

Additional Items

(may be required)

Item#	Description

Recommended Sequence of Application

Item#	Description







Recommended Tools

Personal & Vehicle Protection	Description
Safety Glasses	
Safety Gloves	(Optional)
Vehicle Protection	Blankets, Parts Boxes
Special Tools	
Techstream	Use latest Version on TIS (Do not use Techstream Lite)
Installation Tools	
Screwdriver	#2 Phillips
Nylon Panel Removal Tool	e.g. Panel Pry Tool #1 Toyota SST# 00002-06001-01
Side Cutters	
Torque Wrench	48 in•lbf (5.4 N•m), 88.5 in•lbf (10 N•m)
Tape	Clear, Electrical
Socket	8mm, 10mm, extension
Special Chemicals	
Cleaner	VDC Approved Cleaner
Glass Cleaner	Household Glass Cleaner

Table of Contents

I. Preparation	1–4
1. Table of Contents	2
2. Wire Routing Overview	3
3. Disassembly Overview	4
II. Procedure	5–21
1. Disassembly (Luggage Compartment)	5
2. Disassembly (Passenger’s Side)	6
3. RES ECU Installation	11
4. V4 Wire Harness Installation	12
5. Registration Preparation	14
6. Registration	14
7. Tags and Labels	19
8. Complete the Installation	21
III. Checklist	22–24
1. Accessory Function Checks	22
2. Vehicle Appearance Check	22
3. Vehicle Function Checks	23

Legend

-  Do not proceed until process has been completed.
-  Follow steps carefully to avoid damaging the Vehicle or Accessory
-  Use caution to avoid injury.
-  Used in Figures to call attention to specific tools recommended for the process.
-  Highlights a change in installation with respect to previous issue.
-  Indicates that torque is related to safety.

Accessory Installation Practice (read before installation)

Care must be taken when installing this accessory to ensure damage does not occur to the vehicle. The installation of this accessory should follow approved guidelines to ensure a quality installation.

These guidelines can be found in the “Accessory Installation Practices” document.

This document covers such items as:

- Vehicle Protection (use of covers and blankets, cleaning chemicals, etc.)
- Safety (eye protection, checking torque procedure, etc.)
- Vehicle Disassembly/Reassembly (panel removal, part storage, etc.)
- Electrical Component Disassembly/Reassembly (battery disconnection, connector removal, etc.)

Please see your Lexus dealer for a copy of this document.

1	Spare Tire Cover	6	Glovebox Side Trim	11	PS Knee Airbag
2	Battery Cover	7	Seat Temperature Control Unit	12	Glovebox
3	PS Step Cover	8	Shift Knob	13	Engine Cover
4	PS Cowl Cover	9	Center Console	14	Fuse Box Cover
5	Glovebox Under Cover	10	Center Console Side Trim		

STOP Disconnect all Corresponding Connectors.

Disassembly Overview



 Nylon Panel Removal Tool, 10mm Socket



1. Disassembly (Luggage Compartment)

- a. Place the Vehicle in Park with the Parking Brake set.
- b. Remove the Spare Tire Cover.



- c. Remove the Battery Cover.
 - Press then remove 3 Clips.
- d. Disconnect the Negative Battery Terminal.
 - Note the Battery Cable Position as it will be re-installed in the same position.

 **CAUTION:** Do not touch the Positive Terminal.





Nylon Panel Removal Tool

Fig. 2-1

**2. Disassembly
(Passenger's Side)**

- a. Remove Passenger's Side Step Cover.



Nylon Panel Removal Tool

Fig. 2-2

- b. Remove Passenger's Side Cowl Cover

Fig. 2-3

- c. Remove Glove Box Under Cover.





Nylon Panel Removal Tool

Fig. 2-4

- d. Remove Glove Box Side Trim.

Fig. 2-5

- e. Open Center Console Compartment.

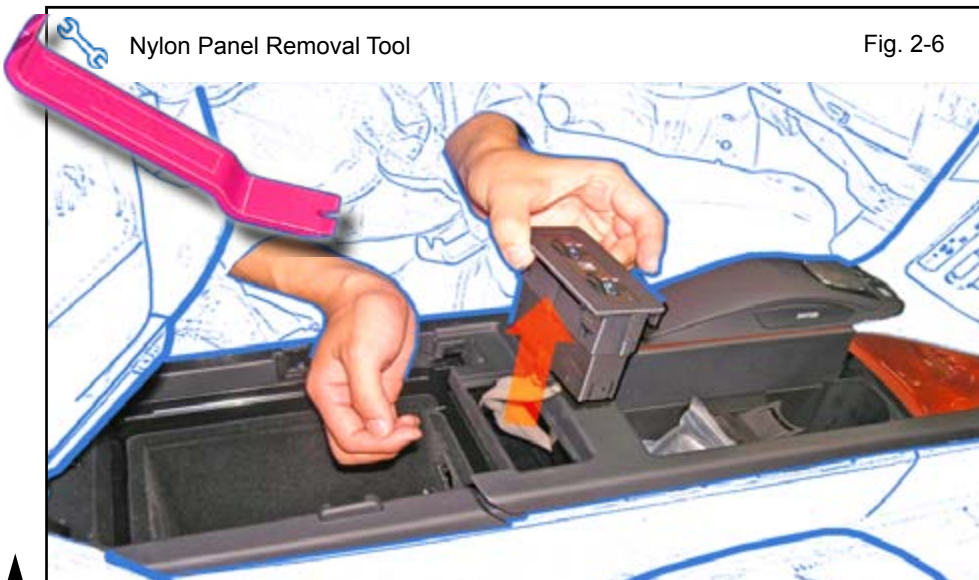

Nylon Panel Removal Tool

Fig. 2-6

- f. Remove Seat Temperature Control Unit.

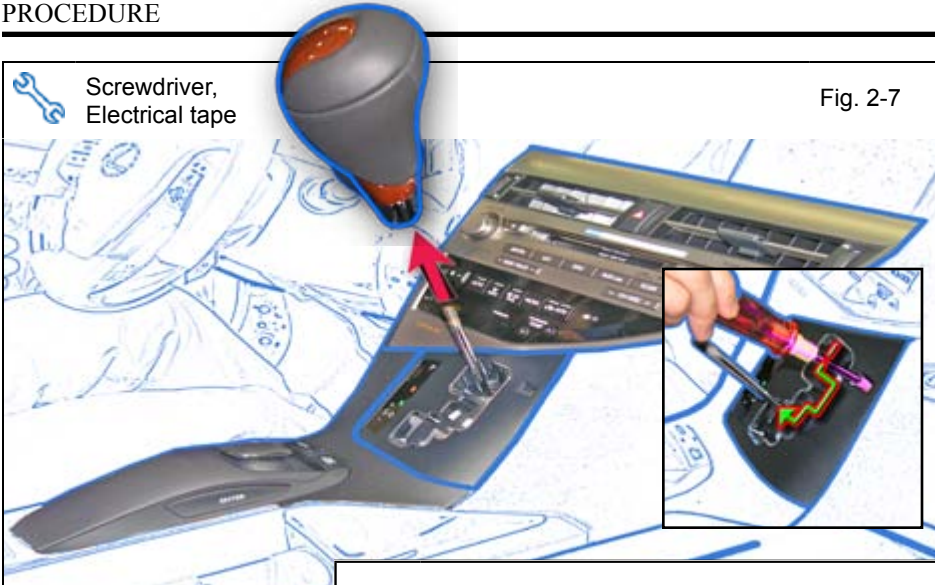

Fig. 2-7

- g. Remove Shift knob by turning counter-clockwise.
- h. Push Shift Release with taped screwdriver and shift to Neutral.



Fig. 2-8

- i. Pull on the Left side Stick Shift Cover, then pull the Center Console up and pull on the Right side Stick Shift Cover.
 - Add Protection Tape on the Shifter and part of the Center Console Compartment area.

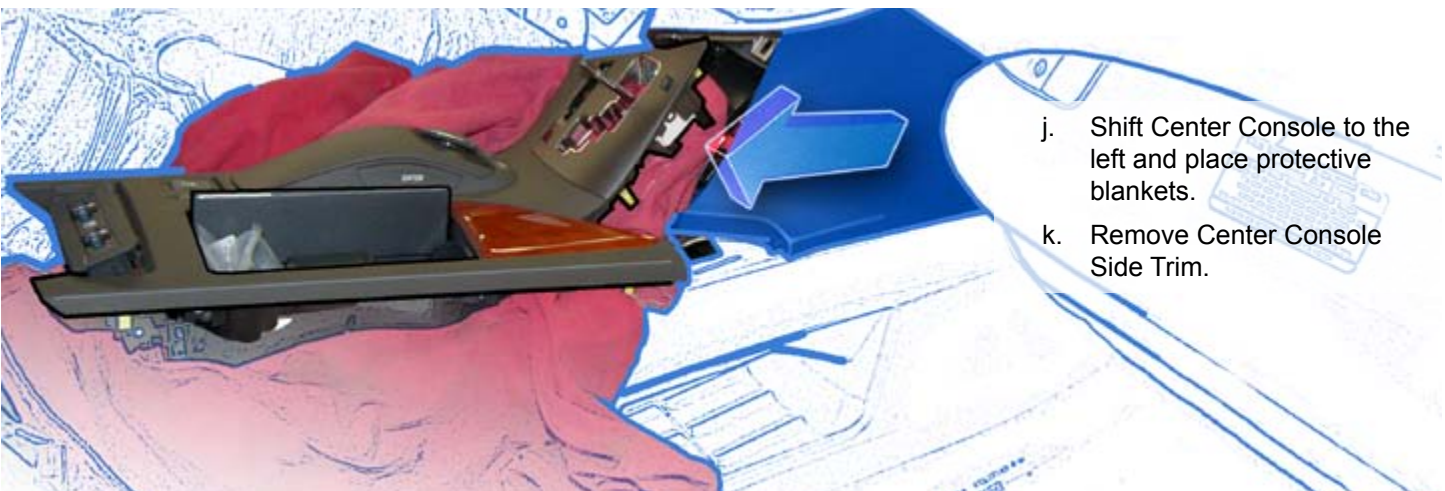

- j. Shift Center Console to the left and place protective blankets.
- k. Remove Center Console Side Trim.

 10mm Socket, Extension

I. Remove 3 Bolts.

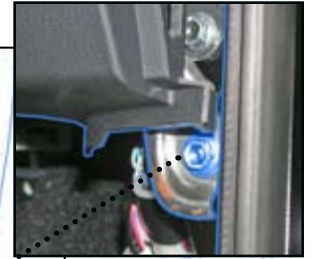

m. Remove Knee Airbag carefully then wrap it and stack on any object to lift it high enough to prevent tension on the Airbag wire.

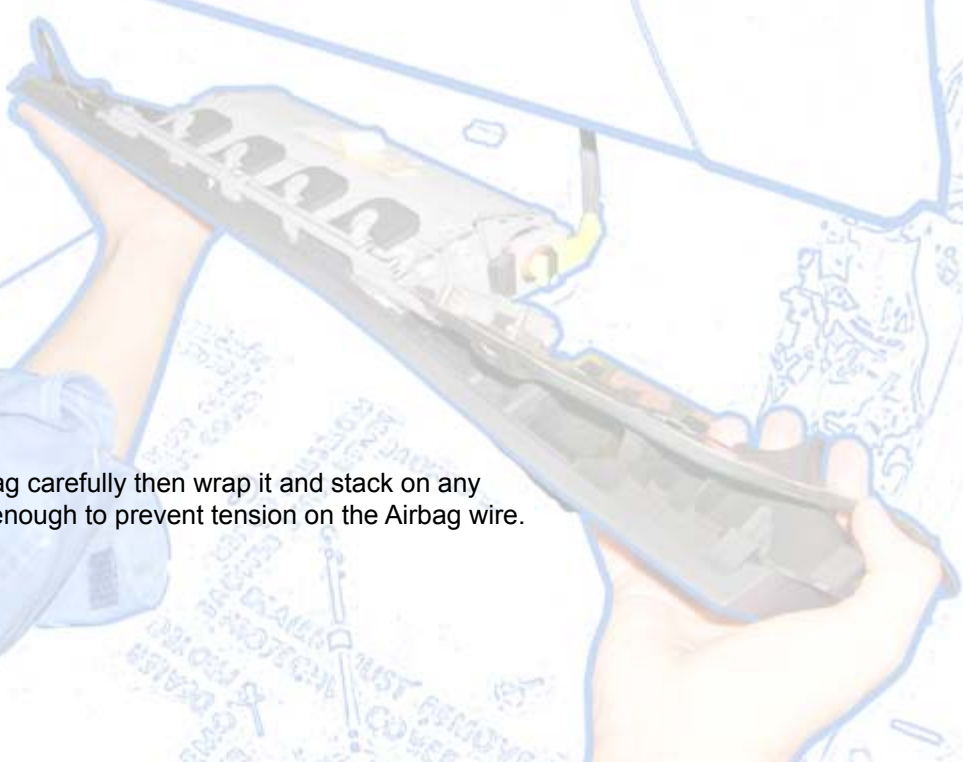

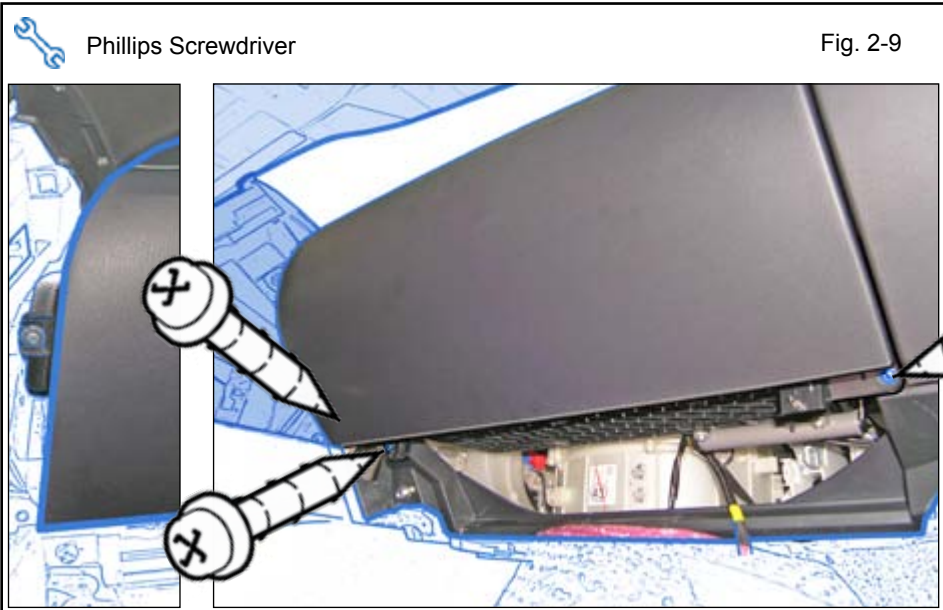

- n. Remove 3 screws at the bottom of the Glovebox.

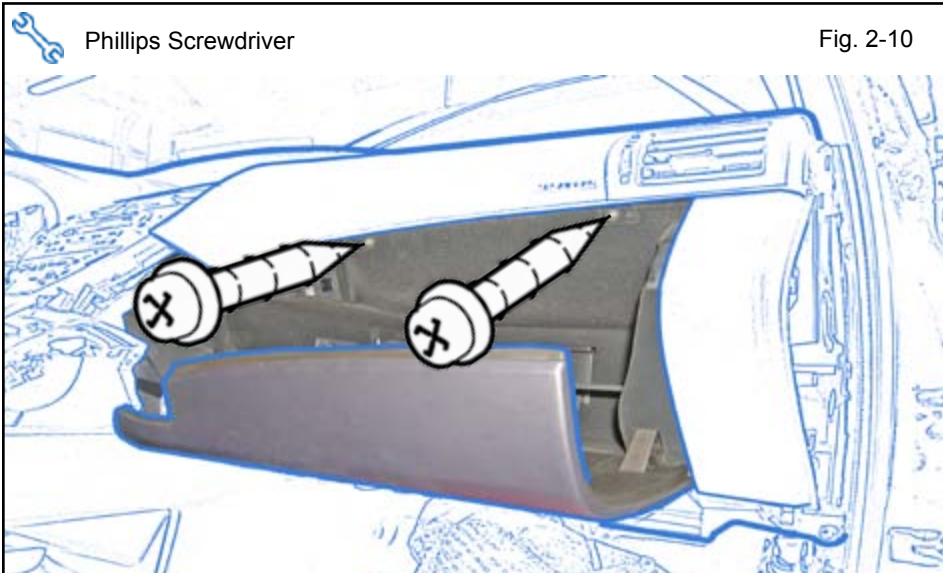

- o. Open Glovebox and remove 2 Screws.



- p. Remove the Glovebox by pulling it towards the left side.

Fig. 3-1



3. RES ECU Installation.

- a. Navigate the RES ECU on the vehicle location shown.

Fig. 3-2

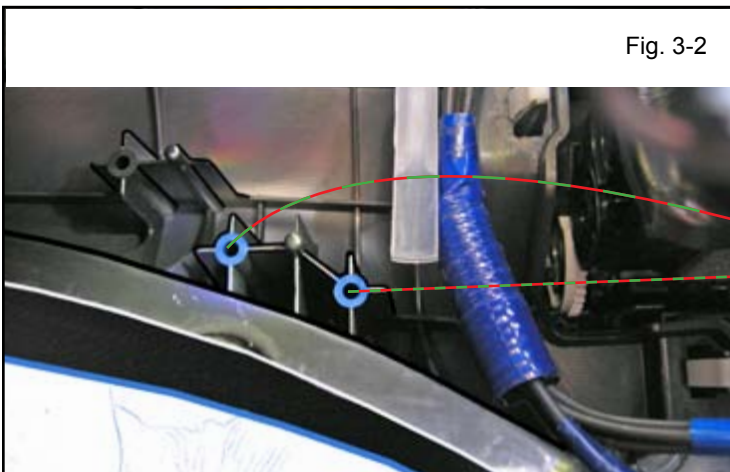

Fig. 3-3



- b. Install the RES ECU to the vehicle using 2 Bolts.

Fig. 3-5



Fig. 4-1

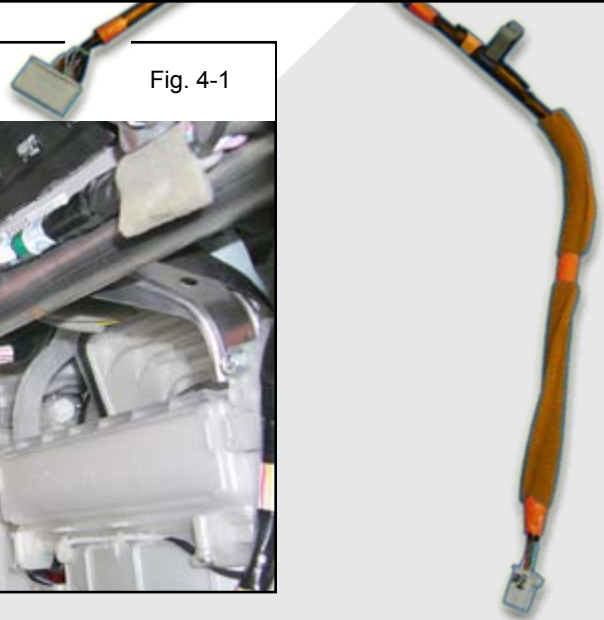
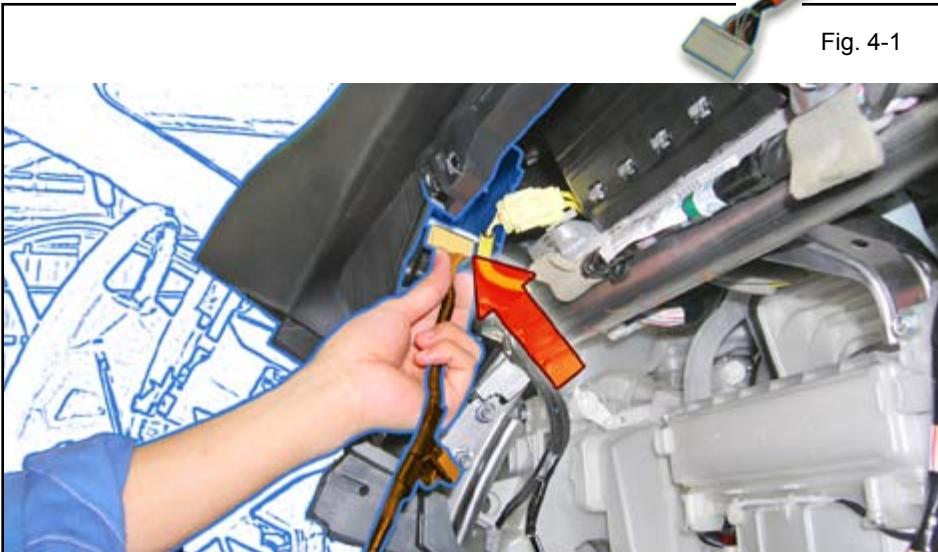

4. V4 Harness Installation.

- a. Connect V4 Harness to the RES ECU.
- b. Use V4 Harness Clamp to secure it to the Vehicle's Harness.
 - Attach clamp over foam tape.

Fig. 4-2



- c. Route the V4 Harness along the Vehicle's Harness, then route the end of the V4 Harness behind the Vehicle's Reinforce.

- d. Plug the V4 Connector to the Vehicle's Pre-Connector in the location shown.

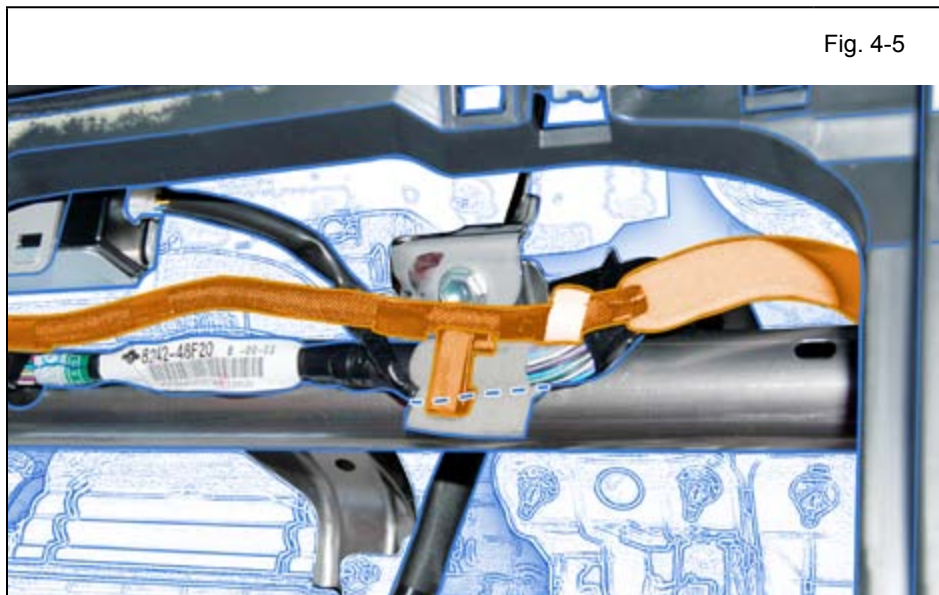

- e. Use V4 Harness Clamp to secure it to the Vehicle's Harness.
 - Attach clamp over foam tape.

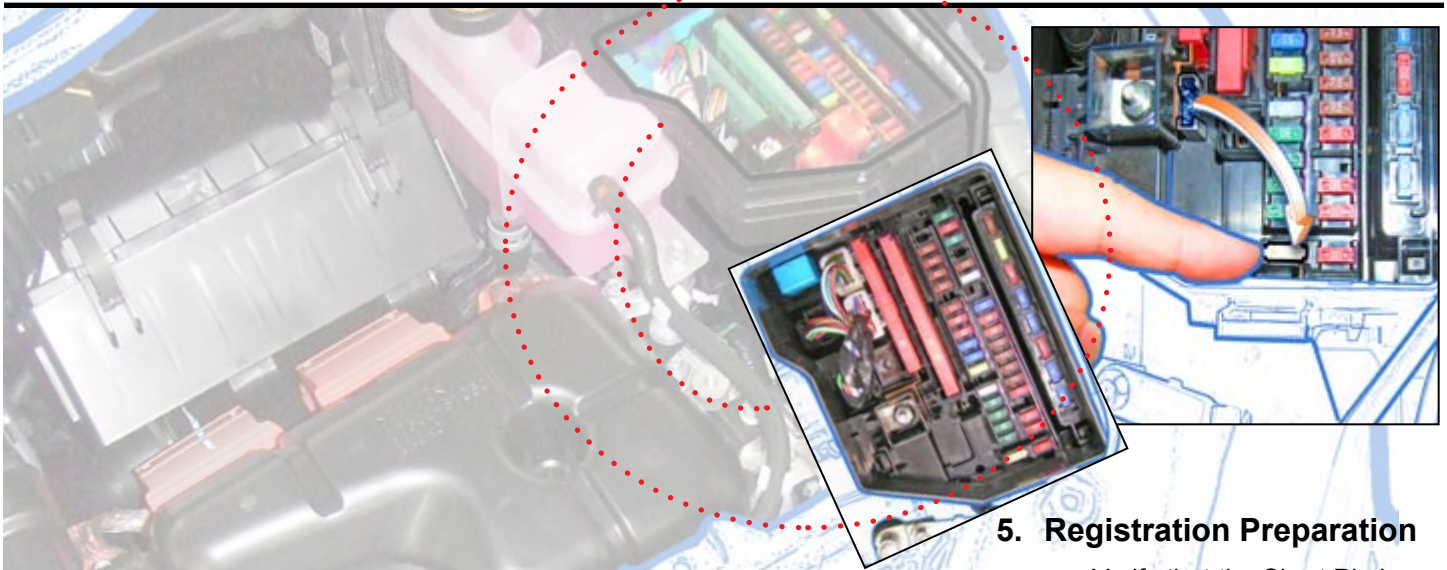

5. Registration Preparation

- a. Verify that the Short Pin is Installed.
 - If not Install now.
- b. Reassemble the Vehicle.

S **NOTE:** When reinstalling Knee Airbag, make sure to tighten the Bolts to 88.5 in•lbf (10 N•m).

STOP **VERIFY:** That all Connectors are reconnected.

STOP **VERIFY:** That panels fit together properly, with no uneven gaps.

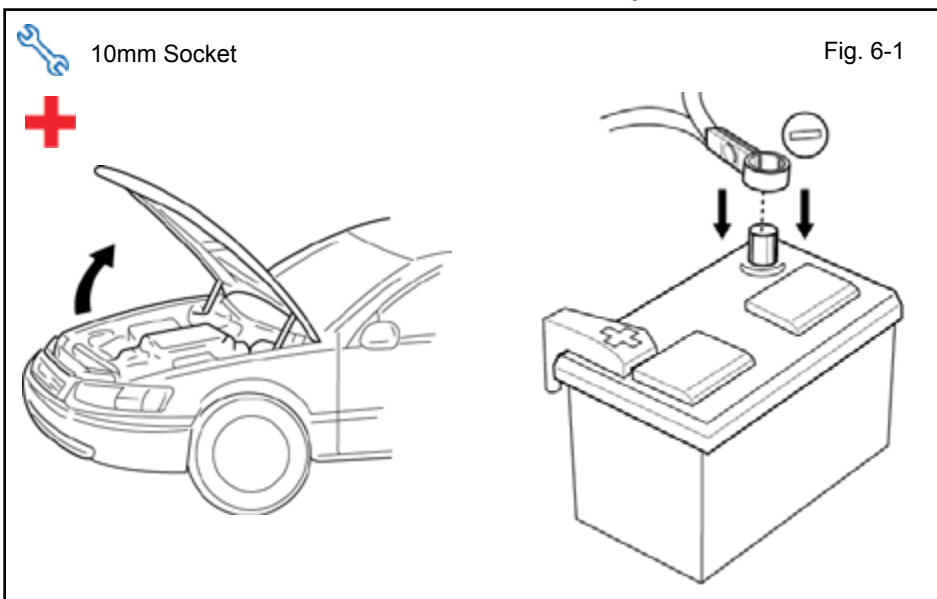
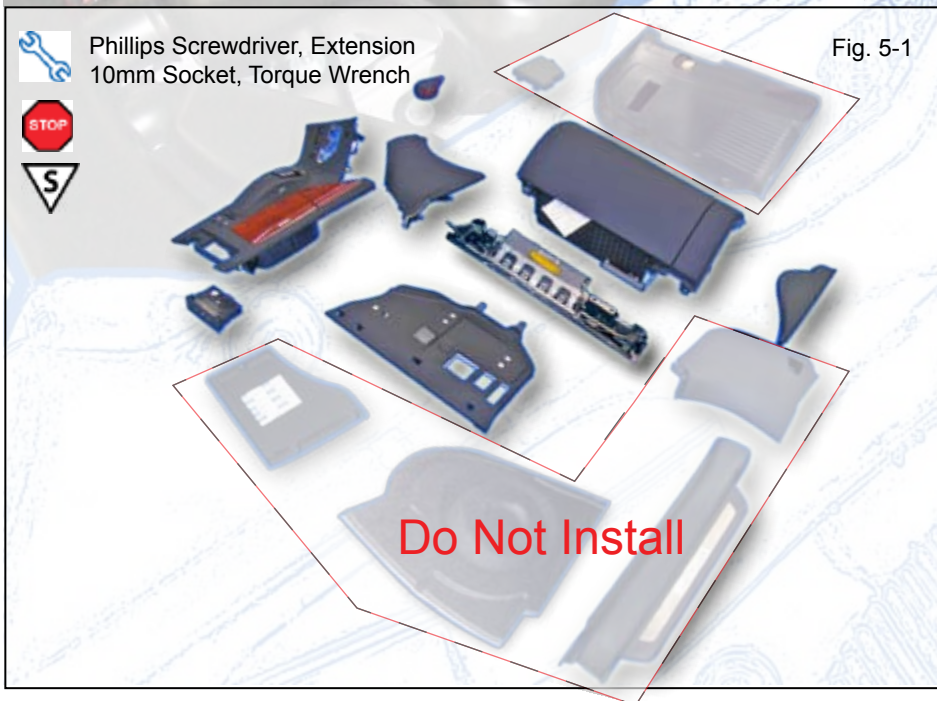

6. Registration

- a. Open the Hood.
- b. Temporarily reconnect the Negative Battery Cable.

+ **CAUTION:** Do not touch the Positive Terminal.

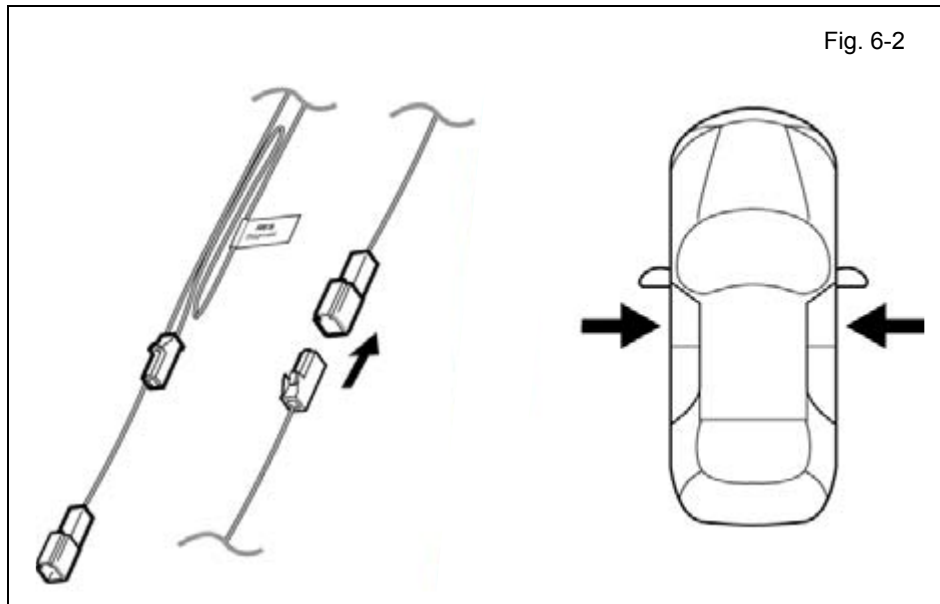

- c. Locate the 1P RES Diagnostic Connectors in the Passenger's Side Cowl Area and connect them.

NOTE: Once connected you will have 10 minutes to complete this section, steps d-y.

- d. Close all doors.

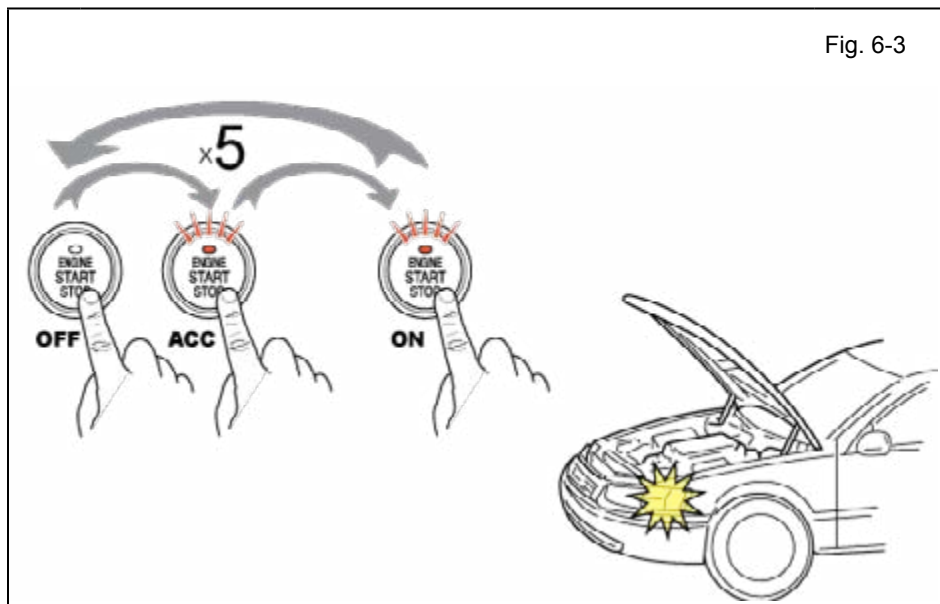

- e. Place the Vehicle in Park (P).
f. With the Remote Control Key in your possession, cycle the Smart Key Ignition Button from OFF to ON 5 times.

NOTE: One cycle consists of: OFF → Accessory → ON. This is equivalent to pressing the Smart Key Ignition Button 14 times.

LOOK: for the Hazard Lights to Flash once.

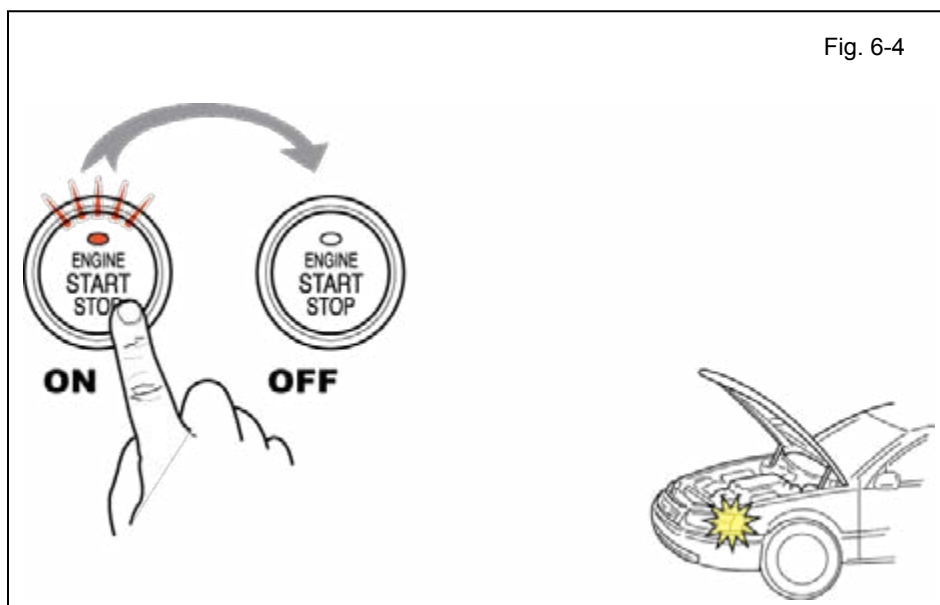

- g. Start the Engine.
h. After 10 seconds stop the Engine.

LOOK: For the Hazard Lights to flash Once.

IF THIS PROCEDURE FAILED

The Hazard Lights flash Three Times.

- Disconnect the Vehicle's 1P RES Diagnostic Connectors.
- Start again from step c.

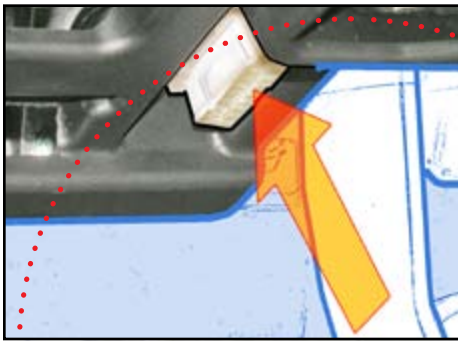

- i. Connect the Techstream Notebook to the Vehicle's Diagnostic Port.
- j. With the Remote Control Key in your possession, press the Power Button twice to select the Ignition "ON" position.

- k. Start the TIS Techstream Application by clicking on the shortcut located on the Desktop.
- l. Click "Connect to Vehicle."
- m. Confirm that the information displayed on the Vehicle Connection Wizard is correct for the vehicle. If not verify that the Techstream is properly connected.
- n. Select "Others."
- o. Click "Next>."

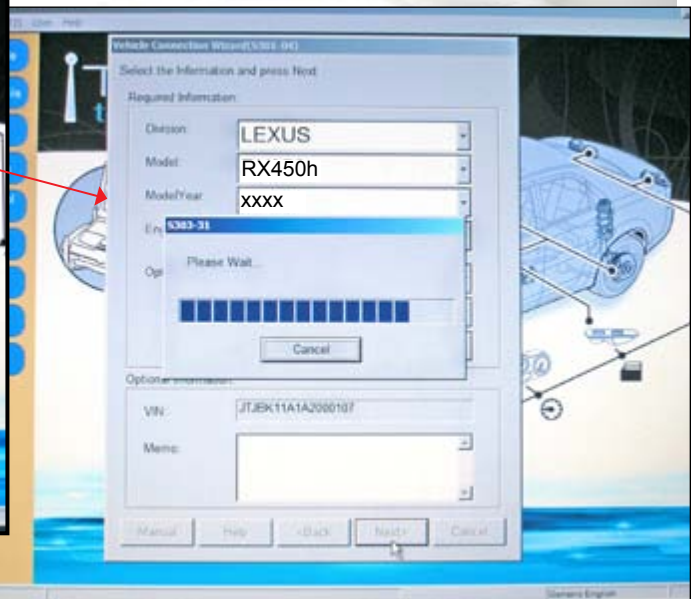
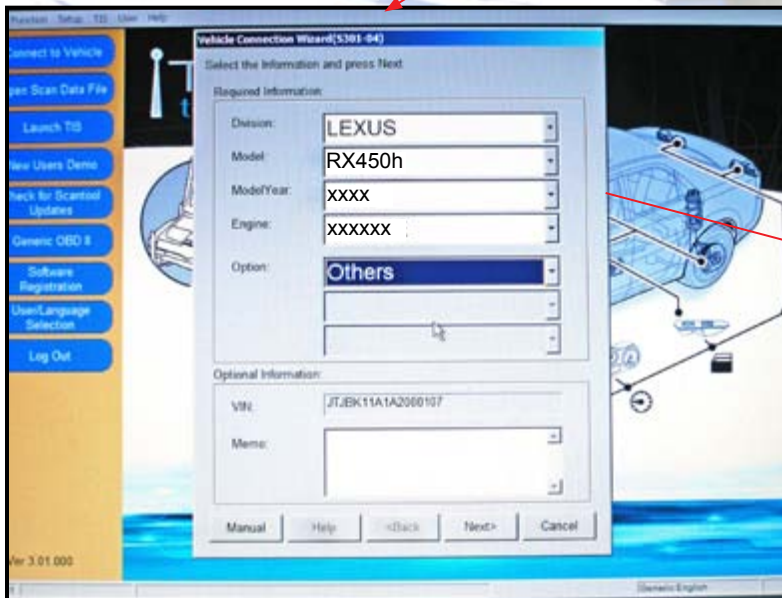

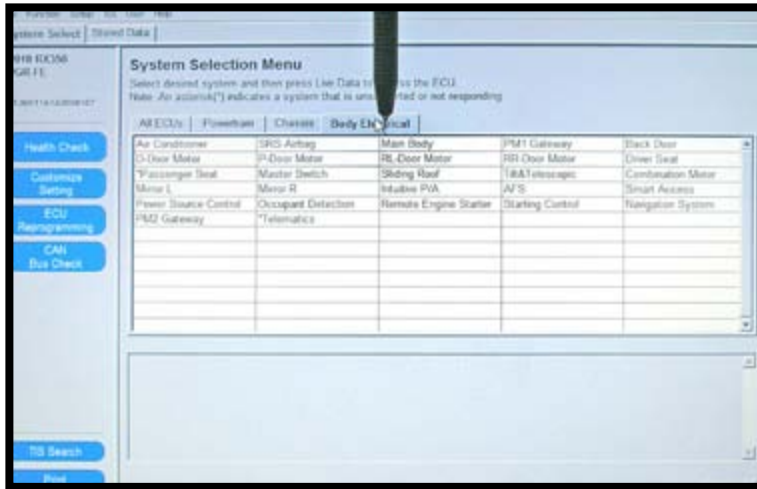

p. Click on the "Body Electrical" Tab.

q. Click on "Smart Access."

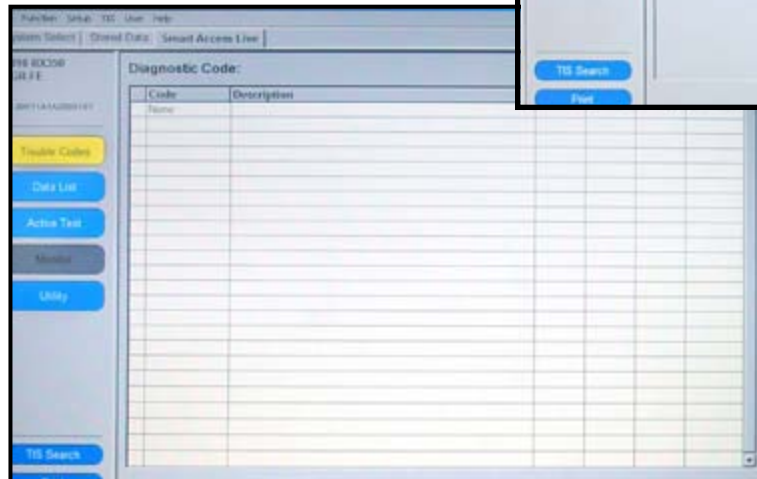
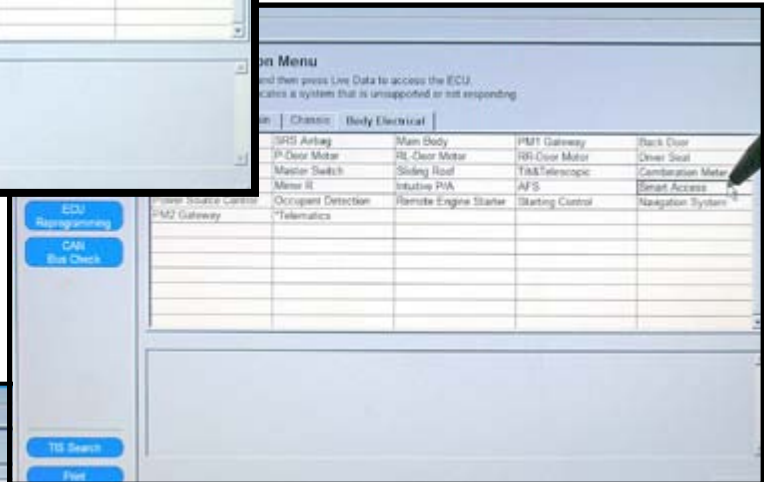

r. This Screen shows up.

s. Click on "Utility."

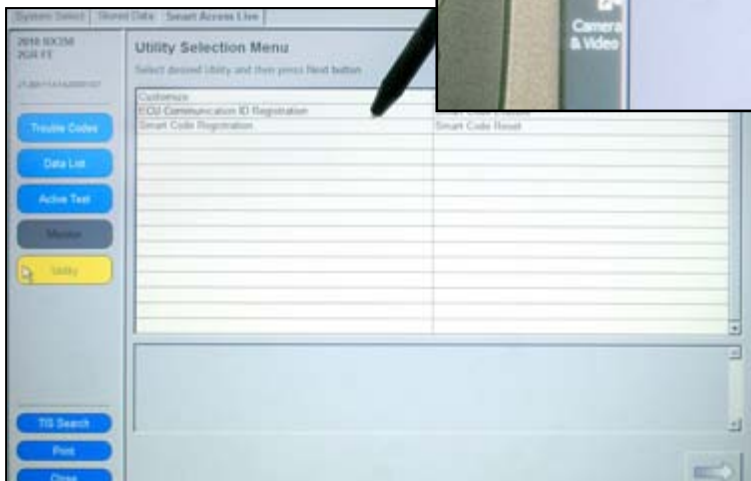
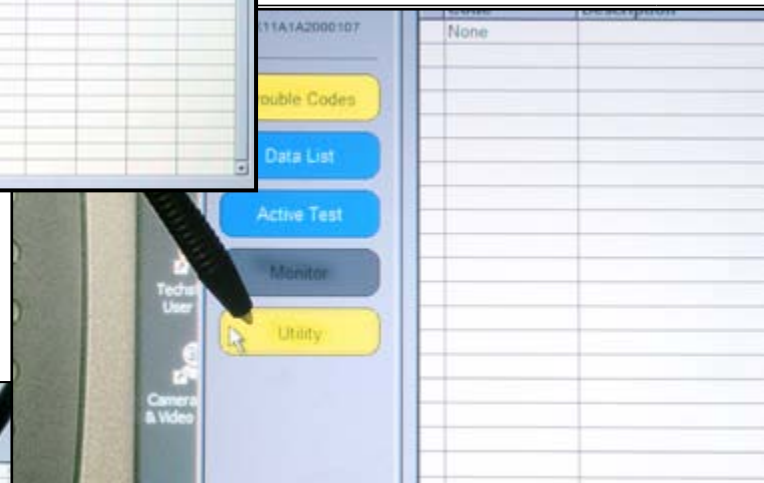

t. Select "ECU Communication ID Registration."

u. Click on .

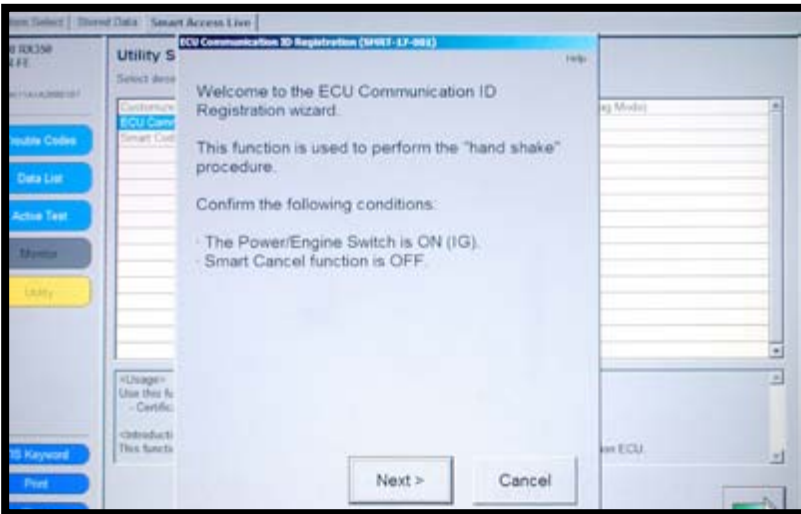

v. Click on "Next>."

- w. Select "Remote Engine Starter."
- x. Click "Next>."

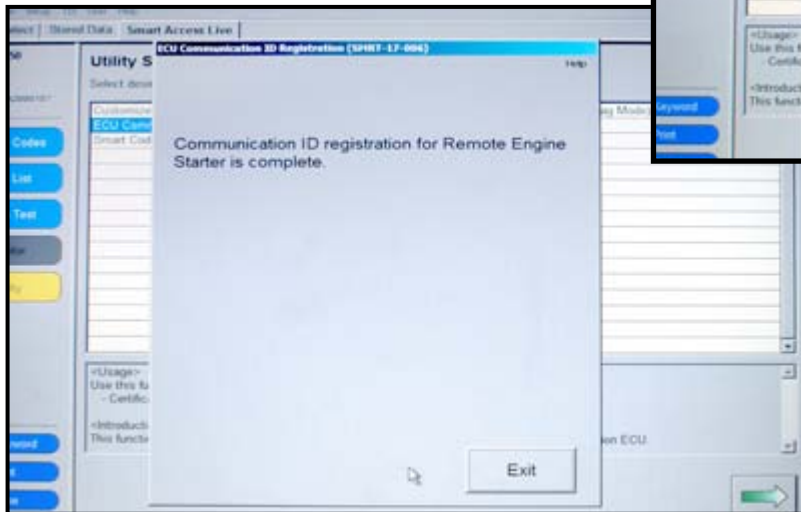
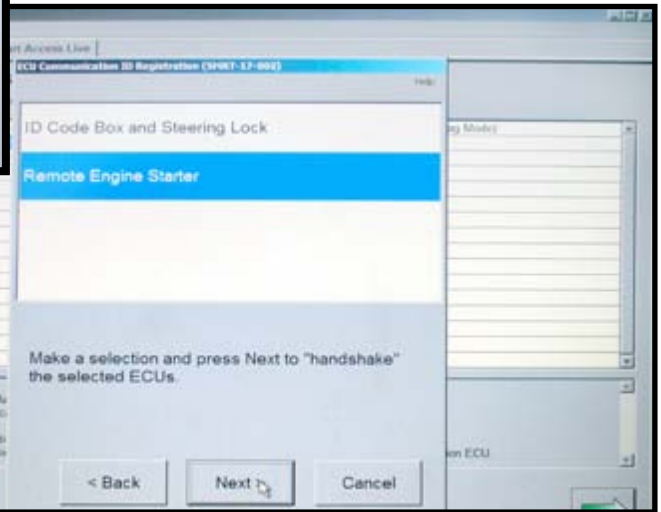

CONFIRM: That the ECU Communication ID was completed successfully.

y. Click "Exit."

IF THIS PROCEDURE FAILED

- Start again from step n.

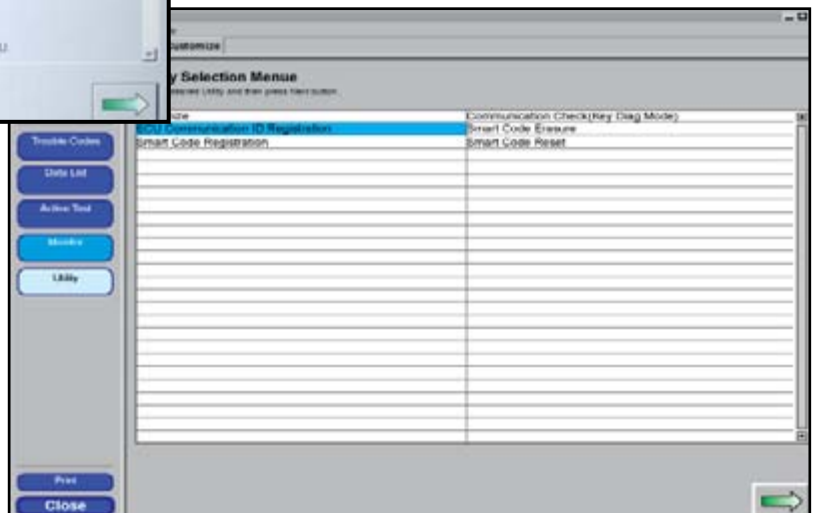

z. Click



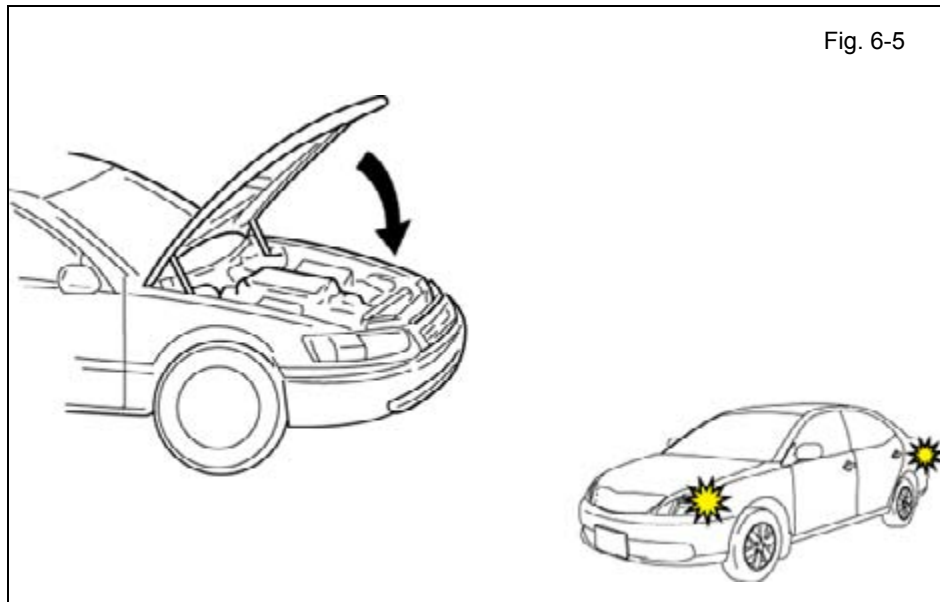

Fig. 6-5

- aa. Exit the vehicle.
- ab. Close the Hood.
- ac. Look for the Hazards to flash twice.

IF THIS PROCEDURE FAILED

The Hazard Lights flash Three Times.

- Disconnect the Vehicle's 1P RES Diagnostic Connectors.
- Start again from step c.

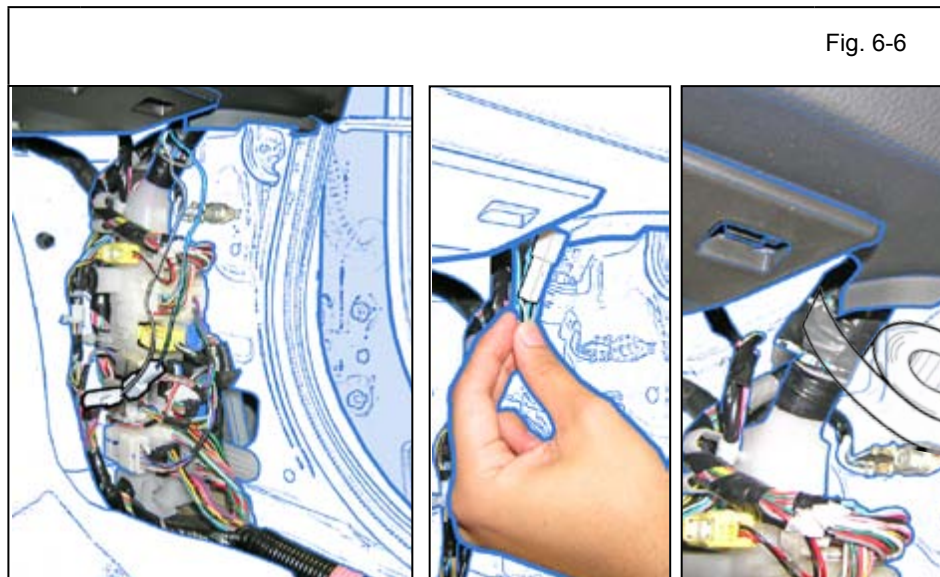

Fig. 6-6

- ad. After a successful Registration Disconnect the 1P RES Diagnostic Connectors.
- ae. Using Electrical Tape secure the Female Connector and Harness to the Vehicle Harness.



Fig. 7-1

7. Tags and Labels

- For US Vehicles use the English Tags and Labels, and discard the Spanish Tags and Labels.
- For Mexico Vehicles use the Spanish Tags and Labels, and discard the English Tags and Labels.
 - a. Using VDC approved cleaner and cleaning method, clean the area indicated in the Engine Compartment.
 - b. Attach the Engine Room Warning Label as shown.



CAUTION: Do not touch the adhesive surface.

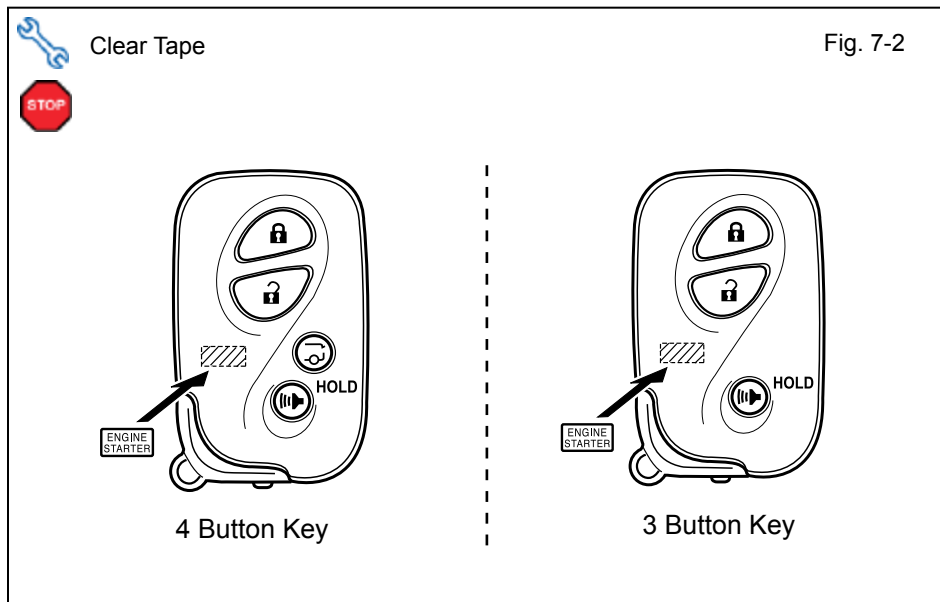

- c. Using VDC approved cleaner and cleaning method, clean the indicated area on the key.
- d. Use a piece of Clear Tape to lift the label off its protective backing.



CAUTION: Do not touch the adhesive surface.

- e. Attach the Key Label as shown.
- f. Attach the Key Tag.

REPEAT: steps c–f with the other Key.

- g. Use Household Glass Cleaner to clean the inside of the Front Door Windows.
- h. Use a piece of Clear Tape to lift the Label from the protective backing.



CAUTION: Do not touch the adhesive surface.

- i. Attach the Label as shown.



NOTE: Make sure to Align according to Etching or Other Label.

REPEAT: steps g–i with the other Window.

8. Complete the Installation

- a. Position the Negative Battery Cable at the original factory position.



- Tighten the Nut to 48 in•lbf (5.4 N•m)



CAUTION: Do not touch the Positive Terminal.

- b. Clean up and Remove trash.
- c. Reinstall the Battery Cover and Spare Tire Cover.
- d. Sealed in its protective bag, place the Owner's Manual in the Glove box.

 Torque Wrench

Fig. 8-1



Accessory Function Checks

Close the hood, enter the vehicle and close all doors. Place the shift lever in the “P” (Park) position, set the parking brake and make sure the Vehicle is off.

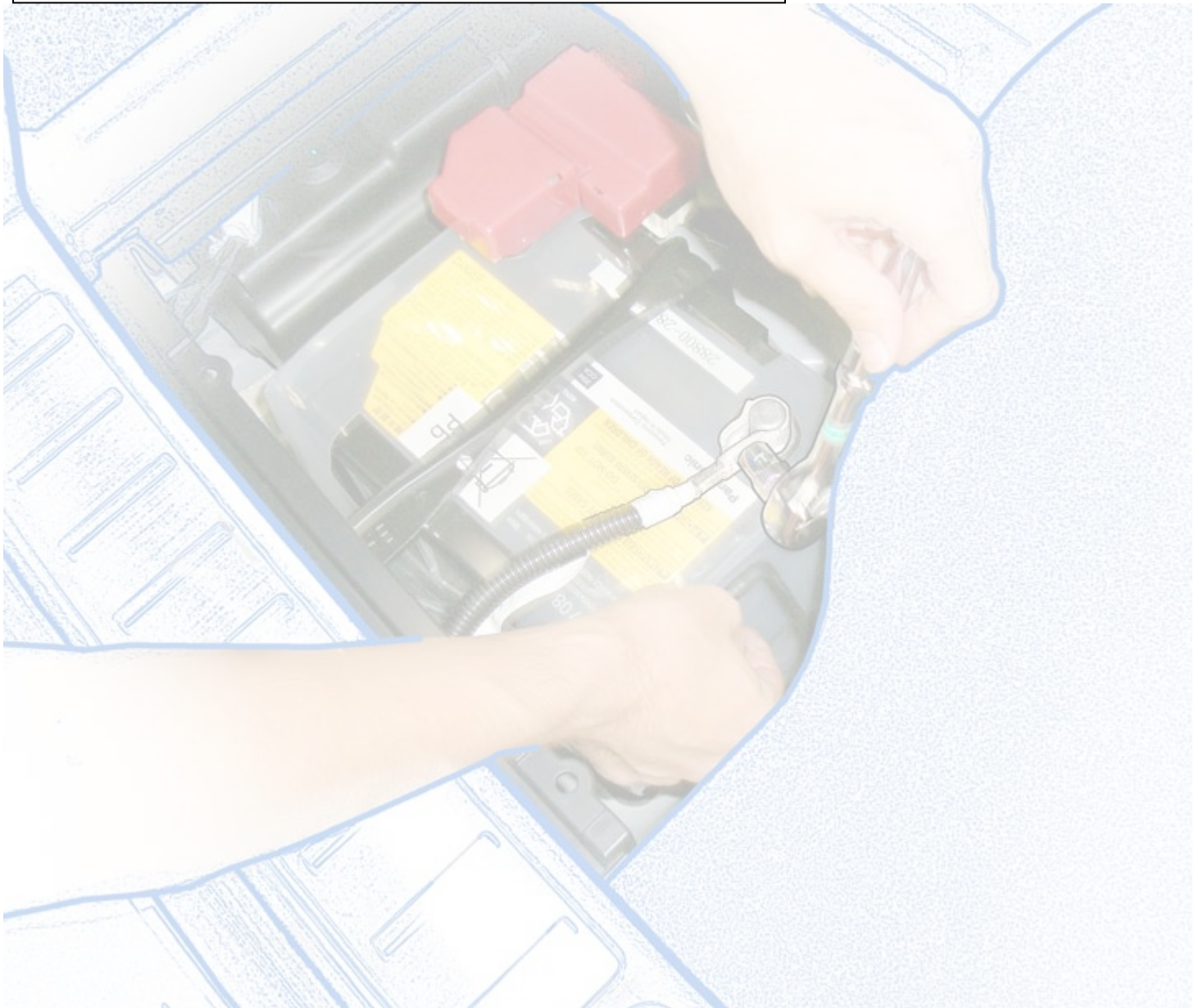
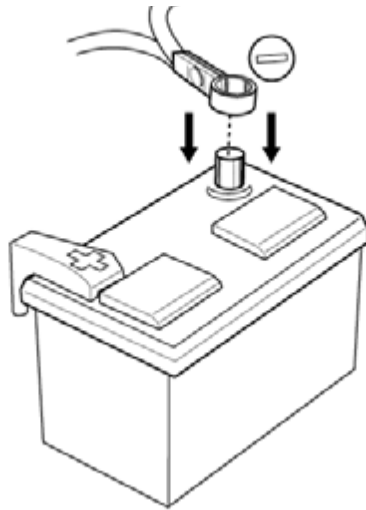
	Perform	Look For
1	Press the remote control’s lock button twice within 2 seconds, then press and hold the lock button for 3 seconds.	The hazard lights flash after 3 seconds. The engine starts. The hazard lights flash repeatedly for 10 seconds.
2	With the engine running, pull the hood release handle. NOTE: <i>Wait 30 seconds before pulling the hood release handle for the Security Alarm to trigger.</i>	The engine stops. The hazard lights flash once. The security alarm triggers. (Only if equipped with OE Factory Alarm, not Genuine Accessory alarm, and only if armed)
3	Move the shift lever out of “P” (Park). Attempt to start the Vehicle using the remote.	The engine does not start.

Vehicle Appearance Check

	Perform	Look For
<input type="checkbox"/>	After accessory installation and removal of protective cover(s), perform a visual inspection of the vehicle.	Ensure no damage (including scuffs and scratches) was caused during the installation process. (For PPO installations, refer to TMS Accessory Quality Shipping Standard.)









Vehicle Function Checks

Function	Function
----------	----------

Enter the Vehicle

<input type="checkbox"/> Dome/Courtesy Lights	<input type="checkbox"/> Steering Wheel Column Adjusts Without Interference
<input type="checkbox"/> Horn	

Start the Vehicle

<input type="checkbox"/> Gauges	<input type="checkbox"/> Panel / Switch Illumination
<input type="checkbox"/> Check Engine Light <i>If the warning light remains on, it may indicate a system malfunction.</i> 	<input type="checkbox"/> ABS Light (if equipped) <i>If the warning light remains on, it may indicate a system malfunction.</i> 
<input type="checkbox"/> Lamp Failure Sensor <i>If the warning light remains on, it may indicate a system malfunction.</i> 	<input type="checkbox"/> Track/Skid Control Light (if equipped) <i>If the warning light remains on, it may indicate a system malfunction.</i> 
<input type="checkbox"/> Seat Belt Warning Light <i>If the warning light remains on, it may indicate a system malfunction.</i> 	<input type="checkbox"/> Tire Pressure Monitoring System (TPMS) <i>Prior to TPMS activation and Pre-delivery Service (PDS) of the Vehicle the TPMS light will blink when IG is turned on.</i> <i>After TPMS activation and PDS of the Vehicle the TPMS light will illuminate for a few seconds and go off when IG is turned on.</i> 
<input type="checkbox"/> Air Bag Warning Light <i>If the warning light remains on, it may indicate a system malfunction.</i> 	
<input type="checkbox"/> Cruise Control Light (if equipped) 	

Using a Mirror or Assistant check the following.

<input type="checkbox"/> Trunk/Tailgate/Bed Lights (if equipped)	<input type="checkbox"/> Tail Lights
<input type="checkbox"/> Brake Lights	<input type="checkbox"/> Daytime Running Lights (if equipped)
<input type="checkbox"/> Backup Lights	<input type="checkbox"/> Marker Lights
<input type="checkbox"/> Clearance Sonar (if equipped)	

Stop the Engine, Place the Vehicle's IG in the ON position.

<input type="checkbox"/> Hazard Lights	<input type="checkbox"/> Turn Signal Lights
<input type="checkbox"/> Head Lights	<input type="checkbox"/> Fog Lights (if equipped)
<input type="checkbox"/> High Beams	<input type="checkbox"/> Accessory Controls/Illumination (if equipped)
<input type="checkbox"/> Power Side Mirrors (if equipped)	<input type="checkbox"/> Convenience Memory Settings (if equipped)
<input type="checkbox"/> Power Sliding Door (if equipped)	<input type="checkbox"/> Rear Sunshade (if equipped)

Function		Function	
<input type="checkbox"/>	Front Wiper/Washer	<input type="checkbox"/>	Rear Wiper/Washer (if equipped)
<input type="checkbox"/>	Power Sun/Moon Roof (if equipped)	<input type="checkbox"/>	Rollover Side Curtain Air Bag Switch (RSCA) (if equipped)
<input type="checkbox"/>	Clock (if equipped)	<input type="checkbox"/>	Navigation System (if equipped)
<input type="checkbox"/>	Audio/Video (if equipped)	<input type="checkbox"/>	HVAC
<input type="checkbox"/>	Steering Wheel Audio Control (if equipped)	<input type="checkbox"/>	Rear Window Defogger (if equipped)
<input type="checkbox"/>	Front Windshield Defogger (if equipped)	<input type="checkbox"/>	Accessory Power Socket (if equipped)
<input type="checkbox"/>	Side Mirror Defogger (if equipped)	<input type="checkbox"/>	Heated/Vented Seats (if equipped)
<input type="checkbox"/>	Massage Seats (if equipped)	<input type="checkbox"/>	Passenger Air Bag Switch (if equipped)

<input type="checkbox"/>	Glove Box Light (if equipped)	<input type="checkbox"/>	Passenger Foot Lamp
--------------------------	-------------------------------	--------------------------	---------------------

<input type="checkbox"/>	Power Locks (if equipped)	<input type="checkbox"/>	Power Windows (if equipped)
<input type="checkbox"/>	Power Seats (if equipped)	<input type="checkbox"/>	Key Sensor Buzzer

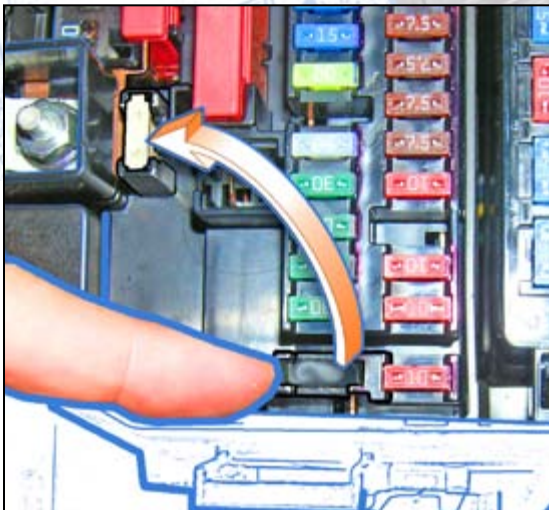

Remove the short pin after Function check.
Check with your Port/Dealer to see if this step is necessary.

Finish reassembling the Vehicle.



VERIFY: That panels fit together properly, with no uneven gaps.

